

# Cordtlandt Pendant

AP1173 1.0

## GENERATION LIGHTING

### Pendant

#### GENERAL PRODUCT INFORMATION:

These fixtures are intended to be installed utilizing NEC compliant junction boxes.

This product is safety listed for damp locations.

Incandescent lamps may be dimmed with a standard incandescent dimmer. LED lamps may be dimmed with a LED dimmer. Consult lamp manufacturer for additional information.

**CAUTION - RISK OF FIRE**

This product must be installed in accordance with the applicable installation code by a person familiar with the construction and operation of the product and the hazards involved.

**Use minimum 90°C supply conductors.**

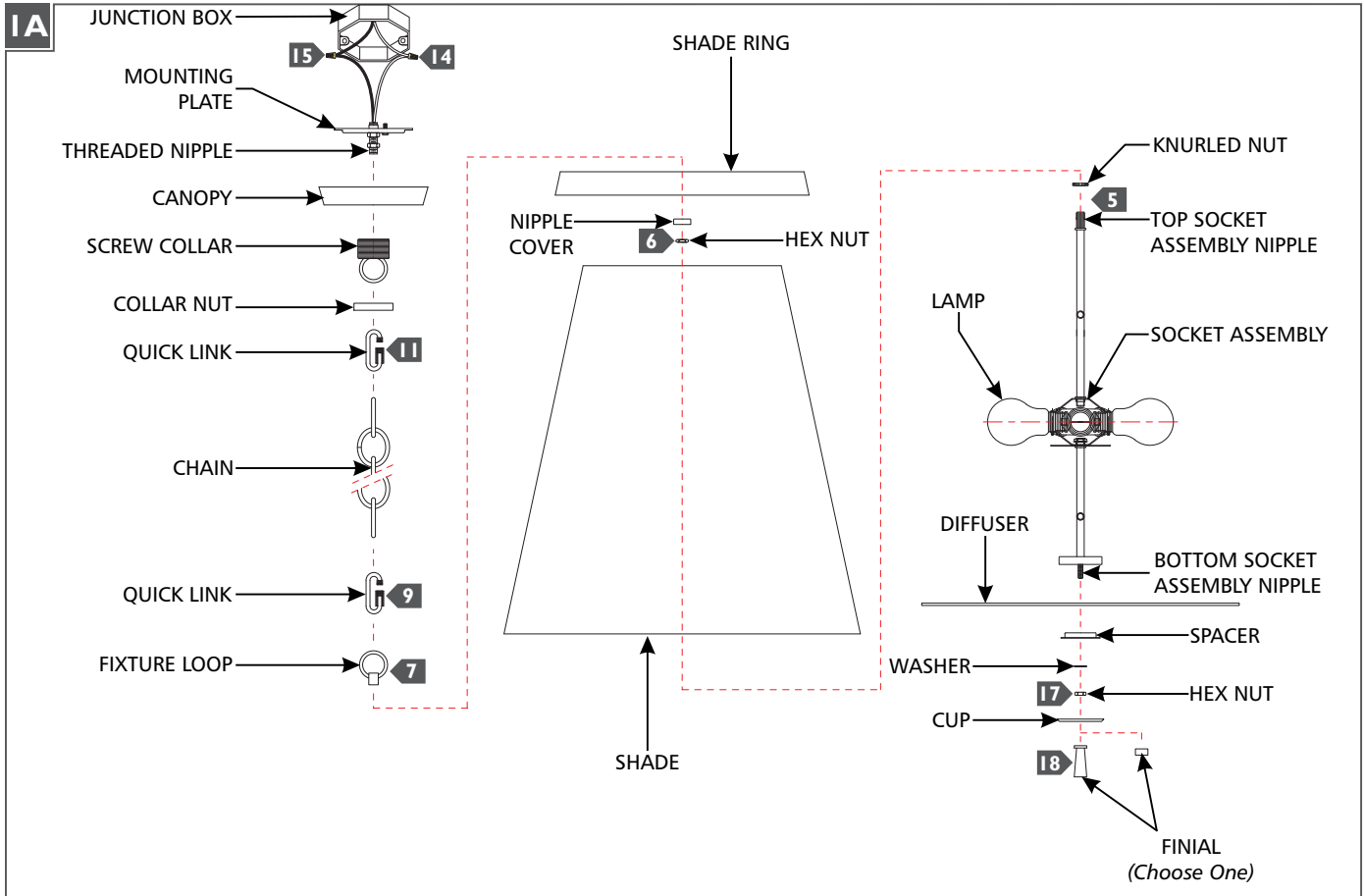

- 1 If necessary, screw the short end of the threaded nipple tightly onto the mounting plate.
- 2 Fasten the screw collar into the bottom end of the threaded nipple and lock into position by tightening the hex nut.
- 3 Secure the mounting plate to the junction box.
- 4 Screw the lamp into the socket. Refer to the label on the socket for Max Wattage Information.
- 5 Feed the fixture wires through the knurled nut and screw it onto the top socket assembly nipple.
- 6 Feed the fixture wires through the shade, hex nut, and nipple cover, then properly place the shade over the top socket assembly nipple and secure it in place by tightening the hex nut onto the nipple. Lower the nipple cover onto the nipple.
- 7 Feed the fixture wires through the shade ring and fixture loop, then lower shade ring onto the shade and screw the fixture loop onto the top socket assembly nipple.
- 8 Determine the wanted height of the fixture and remove a portion of the chain from the bottom by opening a link with pliers.
- 9 Install a quick link to bottom end of the chain, then secure the quick link onto the fixture loop.
- 10 Unscrew the collar nut from the screw collar, then install the collar nut, and the canopy onto the chain (in that order).
- 11 Install a quick link onto the remaining end of the chain, then secure the quick link onto the screw collar
- 12 Weave the cord through the chain, collar nut, canopy, screw collar, threaded nipple, and out of the junction box. Trim the cord leaving enough to make electrical connections.
- 13 Connect the fixture to a suitable ground in accordance to local electrical codes.
- 14 Connect the white fixture wire (square and/or rigid) to the neutral power line wire with a wire nut.
- 15 Connect the black fixture wire (round and/or smooth) to the hot power line wire with a wire nut.
- 16 Neatly place all the wires into the junction box, place the canopy onto the mounting plate, and secure it in place by screwing the collar nut onto the screw collar.
- 17 Place the diffuser, spacer, and washer onto the bottom socket assembly nipple, then secure them in place by screwing the hex nut onto the nipple. **Do not over-tighten.**
- 18 Place the cup onto the bottom socket assembly nipple and secure it in place by screwing the chosen finial onto the nipple.

**SAVE THESE INSTRUCTIONS!**

GENERATION LIGHTING

7400 Linder Ave, Skokie, IL 160077

800.969.3347

**[www.generationlighting.com](http://www.generationlighting.com)**

© 2019 Generation Lighting. All rights reserved.

The "Generation Lighting" graphic is a registered trademark of Generation Lighting. Generation Lighting reserves the right to change specifications for product improvements without notification.